



UNIVERSITY OF WARWICK SCIENCE PARK

HERALD COURT

Herald Court provides flexible accommodation ideal for tech-based businesses. Usage can range from conventional offices for high technology demonstration, training and administration to workshops, laboratory and related uses.

Key Facts

A mixture of high and low bay areas

Part suitable for mezzanine floors

Highly adaptable ground floor accommodation

Units of 3,760 ft² (349 m²) to 5,890 ft² (547 m²) all with individual access

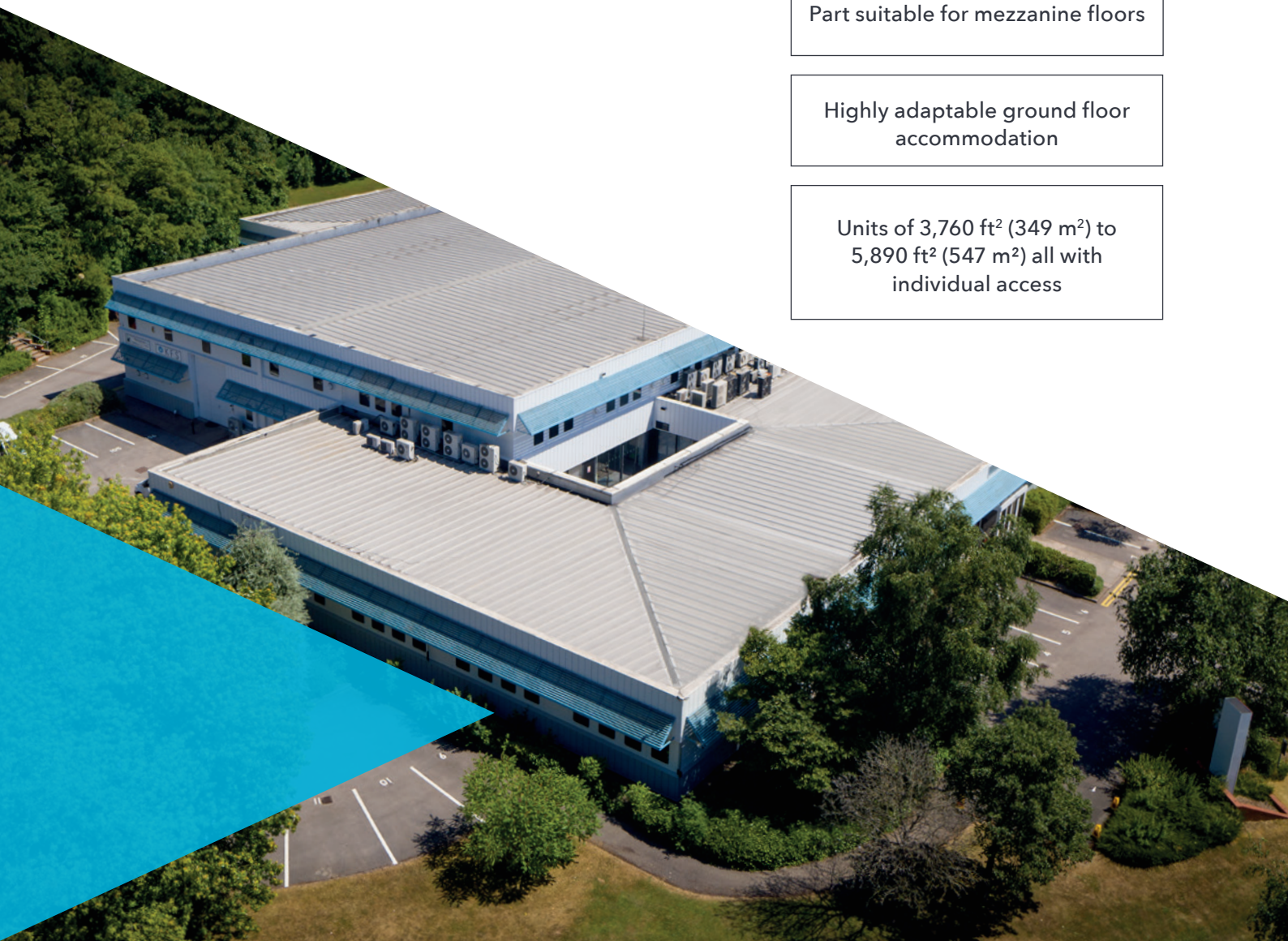



Herald Court: floor plan & unit sizes

Herald Court consists of six independently accessed ground floor units. The four larger units each have nominally 2,000 ft² (186 m²) of high bay multi-purpose-space and an open plan office environment.

- ▲ Main entrance
- ▲ Service entrance
- Atrium
- High bay space
- Toilets

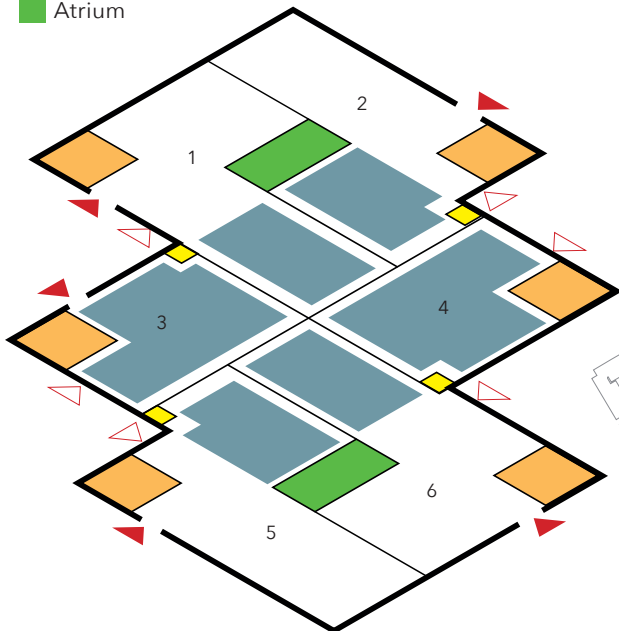

Unit	High bay		Offices		Total area	
	ft ²	m ²	ft ²	m ²	ft ²	m ²
1	1,950	181	3,470	322	5,420	504
2	2,020	188	3,870	360	5,890	547
3	3,760	349			3,760	349
4	3,760	349			3,760	349
5	2,000	186	3,850	358	5,850	544
6	1,950	181	3,480	328	5,430	504

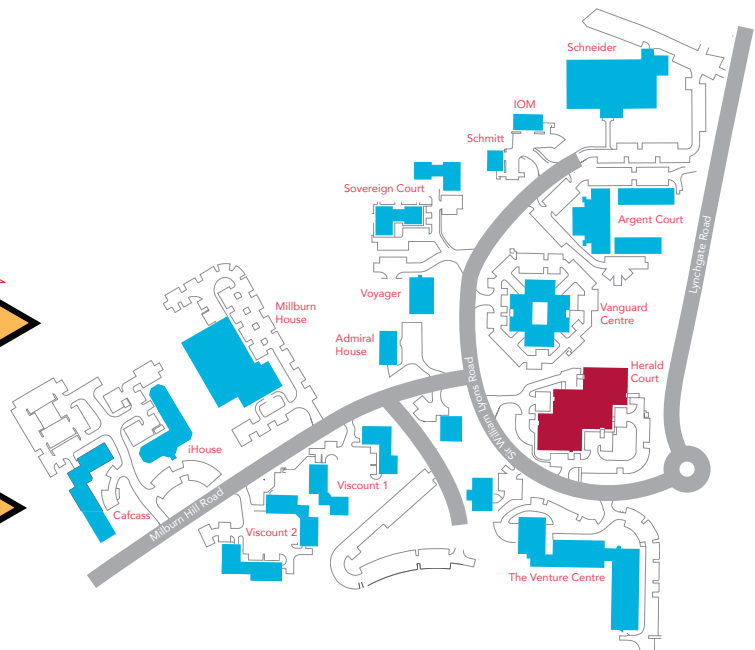

For further information call **024 7632 3000**
more-info@uwsp.co.uk
www.warwicksciencepark.co.uk

University of Warwick Science Park,
 The Venture Centre, Sir William Lyons Road, Coventry CV4 7EZ

UNIVERSITY OF WARWICK
 SCIENCE PARK